



The **DePuro** range of filters are devices that have been specially designed for the primary treatment of water for both household and industrial use. Its unique design and construction mean that it is compact and easy to install, that maintenance is quick and only necessary after a longer period of time and guarantee an ample water flow.

DePuro is usually installed next to the meter provided by the local water supplier. In the case of a household being part of a block of apartments, DePuro would only be for the use of the household in question.

The purification is carried out by six 100% pure polypropylene filter cartridges with a 5 micron level of filtration and the capacity to hold all types of particles

suspended in the filter, from sand and soil (present in the water due to repair work carried out by the local water supplier) to smaller particles like iron (red in colour) that make the water unusable for household and general sanitary needs.

Code	Description	Pcs. per package	Pcs. per carton / pallet
<b>DRO100-5</b>	<b>DEPURO CONTAINER + 6 HIGH PURE FILTERS 9" PP 5µm</b>	1	8 / 30

#### Maintenance:

Code	Description	Pcs. per package	Pcs. per carton / pallet
<b>K10CA27405</b>	<b>DEPURO MAINTENANCE KIT DRO100-5</b> (6 HIGH PURE FILTERS 9" PP 5µm + O-RING + DUCT GASKET)	1	/ 100

#### Technical data:

DIMENSION LxWxH:	330x240x350 mm
CONTAINER - Material:	PP+30% mixed fibre glass
HEAD - Material:	PP+30% mixed fibre glass
COVER - Material:	PP COPOLYMER
H <sub>2</sub> O INLET CONNECTION:	1" Female
H <sub>2</sub> O OUTLET CONNECTION:	1" Female
H <sub>2</sub> O DRAINAGE PRESSURE:	¼" Female
GASKETS:	Red Silicone 70 FDA
N° FILTERS:	6
FILTER CONNECTION:	AQ BAYONET JOINT
TYPE OF FILTERS:	HIGH PURE – PP series
LEVEL OF FILTRATION:	5 microns
OPERATING TEMPERATURE min. max:	10 - 38 °C
H <sub>2</sub> O OPERATING PRESSURE min. max:	150-400 kPa (1,5-4 bar)
H <sub>2</sub> O PRESSURE LOSS: <small>The reported value is in relation to operating with clean filter cartridges with a water pressure of 2.5 bar and a quantity of water with a medium level of pollution.</small>	10 kPa (0,1 bar)
WATER SUPPLY CAPACITY:	2,1 m <sup>3</sup> /h – P. 2,5 bar
FILTER DURATION:	1 year
WEIGHT WITH PACKAGING:	5,9 Kg
CERTIFICATION MARK:	CE
PRINCIPAL GUIDELINES AND STANDARDS:	Min.Ord. N° 34 23rd March 1973 and successive applicable orders

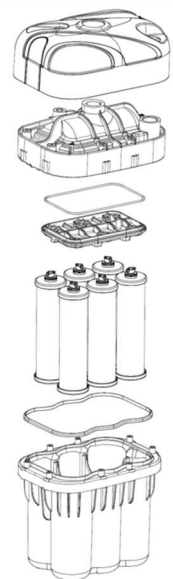

Compliant with decree n°25 25th February 2012:

Technical provisions concerning equipment used for the purpose of treating water destined for human consumption.

**Accessories:**

Code	Description	Pcs. per package	Pcs. per carton / pallet
<b>DROBP1/2</b>	<b>System by-pass 1/2"</b> (n.1 non-return valve, n.2 ball valves, n.2 3-way ball valves, n.2 flexible pipes)	1	/
<b>DROBP3/4</b>	<b>System by-pass 3/4"</b> ( n.1 non-return valve, n.2 ball valves, n.2 3-way ball valves, n.2 flexible pipes)	1	/
<b>DRXSTSO1</b>	<b>DePuro / DePuriX Painted sheet metal suspension bracket</b>	1	/